

From With(in)
MAIN GALLERY GEORGE PATON GALLERY
EXHIBITION DATES: 13-24 March 2023
EXHIBITION CELEBRATION: 5-7pm Thursday 23 March

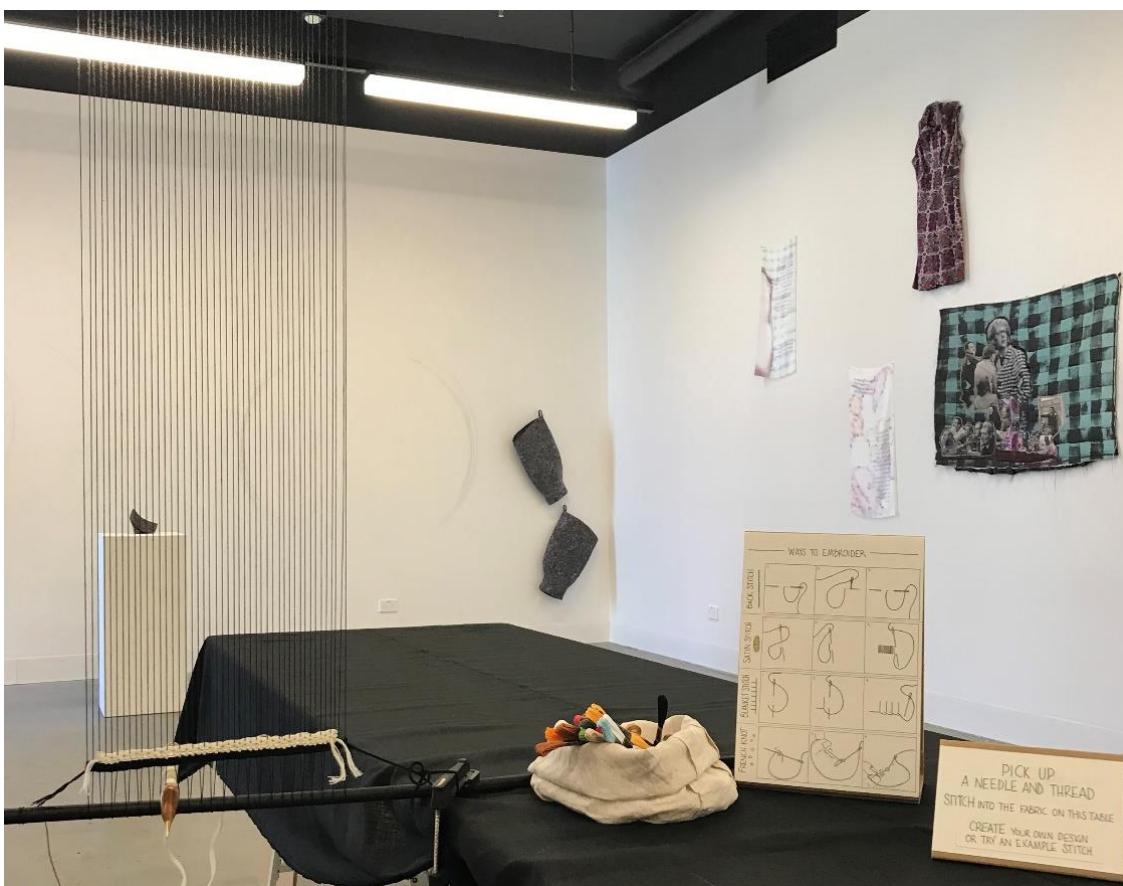

From With(in)
Helvi Apted, Britt Salt and Shannon Slee



From With(in) presents the work of three artists whose practices are connected by a shared workspace and language of materials, using textile methodologies as a springboard for broader research. The artists invite visitors to take part in textile actions alongside them as they expand, transform and multiply artworks over the course of the exhibition.

IMAGE: Helvi Apted, Shannon Slee and Britt Salt, *From With(in)*
Installation detail. George Paton Gallery, March 2023

We acknowledge the traditional custodians of the land on which this show takes place, the Wurundjeri people. We acknowledge that this is stolen land, and that sovereignty has never been ceded. It always was and always will be, Aboriginal land.

GEORGE PATON GALLERY

Level 1, Arts and Cultural Building, The University of Melbourne
11am-5pm Monday to Friday | umsu.unimelb.edu.au/gallery | gpg@union.unimelb.edu.au

LIST OF WORKS

1. Shannon Slee, see below for arrangement of works
2. Helvi Apted, *Sleeve Drawings*, felt, thread, elastic, wax crayons, 2023.
3. Britt Salt, *Two Water Pipes Reflected onto the Wall of a Gallery*, 2023,
4. Britt Salt, *Six Vertical Threads Over Six Horizontal Threads*, 2022, wool and cotton, 94 x 98 cm.
5. Helvi Apted, Britt Salt, Shannon Slee and participants, *Textile Action*, 2023, linen, thread, yarn, n cotton, wood, needles, embroidery hoops, cardboard ..., dimensions and duration variable.

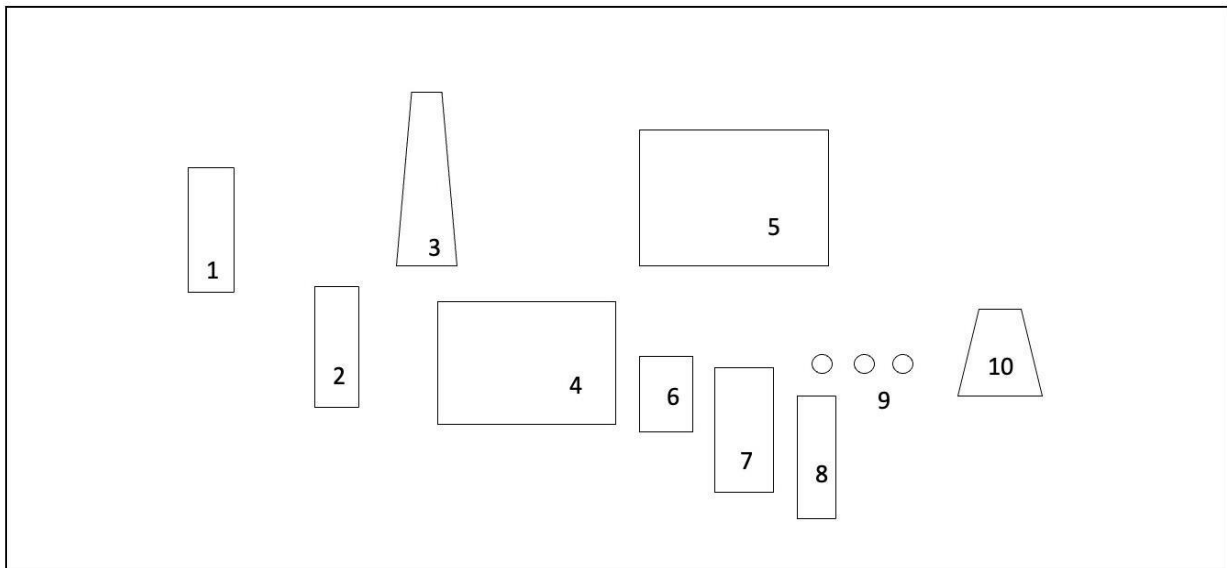

1. Shannon Slee, *Silk Banner #1*
Digital print on silk, 33cm x 75cm, 2023.
2. Shannon Slee, *Silk Banner #2*
Digital print on silk, 33cm x 75cm, 2023.
3. Yvonne's dress, on loan.
4. Shannon Slee, *On the Back of Her Skirt*
Digital print on linen and cotton drill, thread, batting, found skirt, 100cm x 71cm, 2023.
5. Shannon Slee, *Quilting for Gerry*
Digital print on cotton drill, thread, fabric remnants, batting, 106cm x 80cm, 2022.
6. Shannon Slee, *Embroidery for Barb*
Cotton embroidery thread on artists own silk remnant, 37cm x 27cm, 2022.
7. Shannon Slee, *Weaving for Yvonne*
Twill wool weaving from 4-shaft loom, 30cm x 70cm, 2022.
8. Shannon Slee, *Silk Banner #3*
Digital print on silk, 33cm x 75cm, 2023.
9. Shannon Slee, *Peace Badges #4, #5 & #6*
Embroidery thread on denim, 9.5 cm diameter, 2023.
10. Barb's silk embroidered shirt, on loan.

ACKNOWLEDGMENTS

The artists would like to thank Sandie and Channon from George Paton Gallery for their generous support in bringing this exhibition to fruition.

Britt, Helvi and Shannon would like to thank Mia Palmer-Verevis and Izzy Baker for their insightful written response for *From Within*.

Shannon would like to thank key contributors to her work Yvonne Crofts, Barbara Slee and Gerry Baker for kindly sharing their experiences of protesting in Naarm/ Melbourne in the early 1970s.

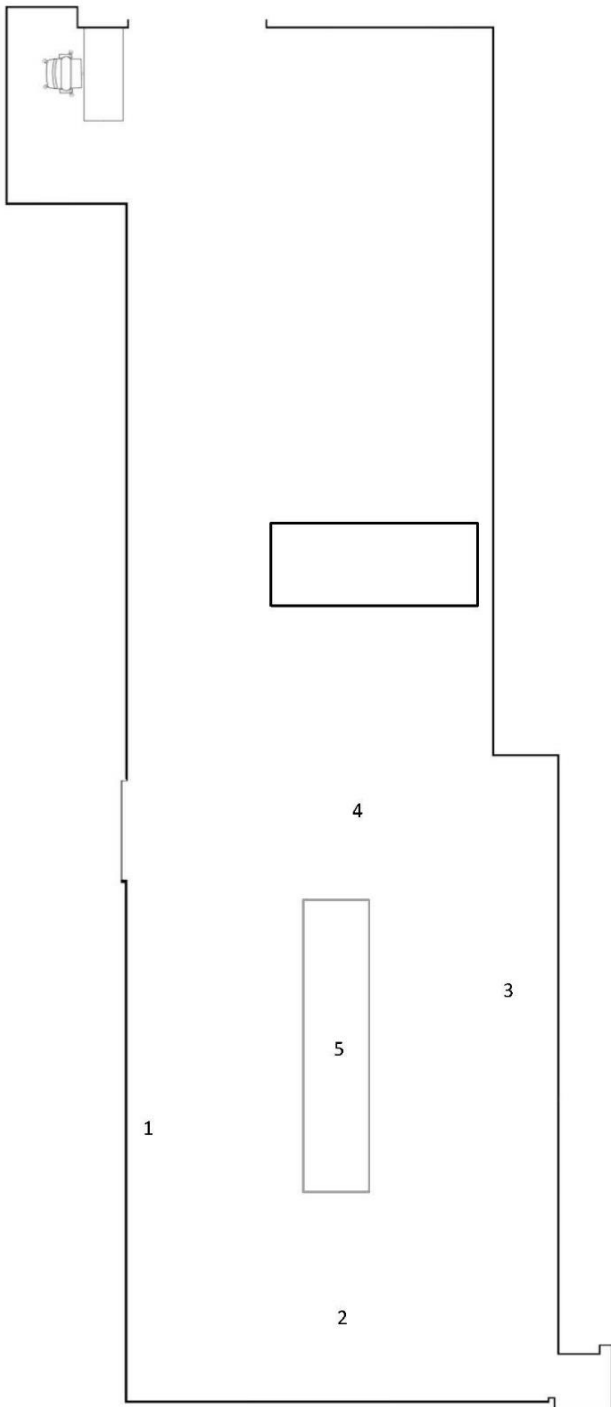

ARTIST ENQUIRIES

Helvi Apted | helvi.apted@gmail.com

Britt Salt | tobrittsalt@gmail.com

Shannon Slee | shannonslee10@gmail.com

